

SECTION 21, T.7N., R.1E., S.L.B. & M.  
LIBERTY DISTRICT

SCALE 1" = 400'

TAXING UNIT: 36

SEE PAGE 6

SEE PAGE 10

SEE PAGE 15-4

SEE PAGE 15-1

PARK DISTRICT  
LIBERTY  
NO. 5 MAINTENANCE AREA

SEE PAGE 17

SEE PAGE 13

SEE PAGE 15-3

SEE PAGE 15-2

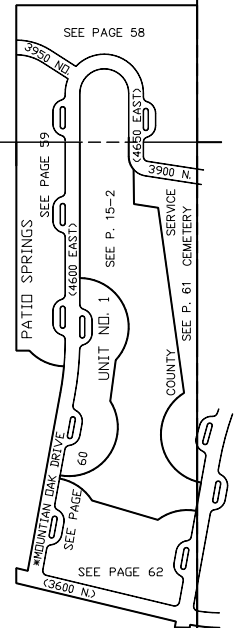

SEE PAGE 16

WEBER COUNTY LIBERTY CEMETERY SERVICE AREA NO. 5 MAINTENANCE LIBERTY PARK DISTRICT

SEE PAGES 73 & 74

\* STREET NAME CHANGE 19-JAN-95 1744-1014

SEE PAGE 22

EDEN HILLS SUB. NO. 3